

BUILDING SECTION 1
 3/32" = 1'-0" A-300

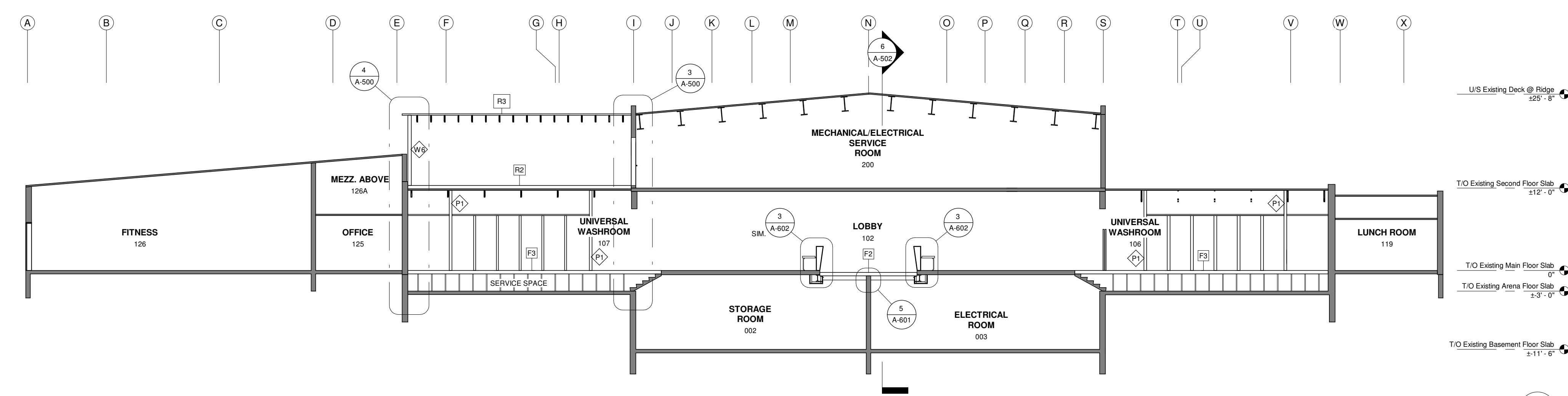

BUILDING SECTION 2
 3/32" = 1'-0" A-300

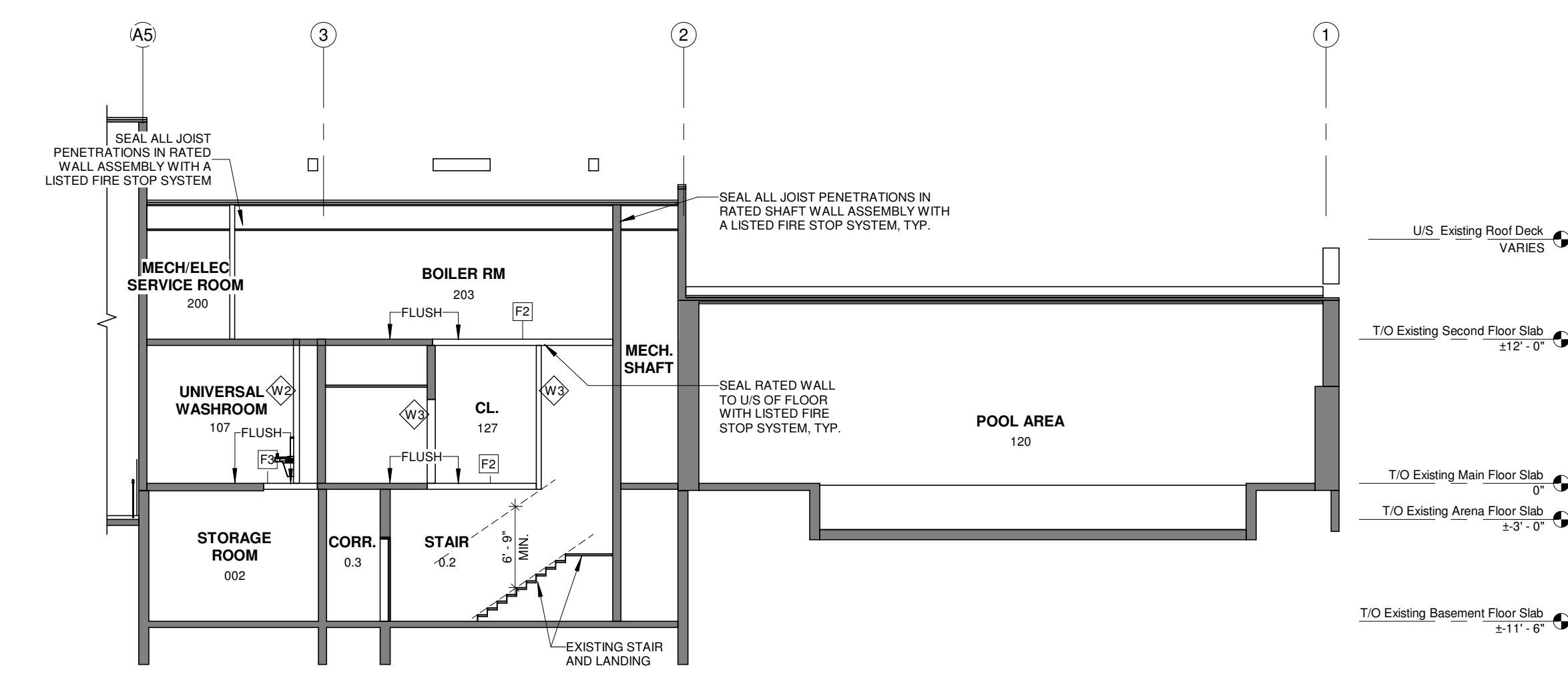

BUILDING SECTION 3
 3/32" = 1'-0" A-300



This drawing must not be scaled. The contractors shall verify all dimensions and other data on site prior to commencement of work. Discrepancies, errors, and omissions are to be reported to Public City Architecture Inc. prior to proceeding with the Work.

Drawings and specifications as instruments of service are the property of Public City Architecture Inc.; the copyright in the same being reserved.

No reproduction or revision to these drawings may be made without the permission of Public City Architecture Inc., and when made, must bear their name. All prints to be returned to Public City Architecture Inc. upon request.

Project
**St. James Civic Centre
 Phase 2 Building Systems
 Upgrades**
 2055 Ness Avenue

Drawing
BUILDING SECTIONS

Drawn By: AD	Review By: AL
Scale: AS NOTED	Tender No: 1176-2019
Date: NOV. 6, 2019	
Sheet:	A-300